

Key Features

- Simple single-room pressure indication for all pressurized spaces
- Integrated Setra Pressure transducer
- Visual alarm via red/green light ring
- Door delay
- Configurable audible alarm
- Digital display can be always-on or momentary
- Analog Output
- Easy configuration
- Sleek and attractive single wall plate

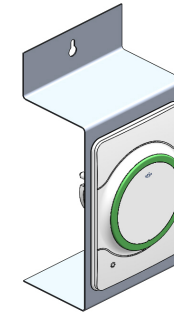

	Standard	Dual Alert	Quick-Mount Kit
Use Case	Simple permanent monitoring of airflow	Simple permanent monitoring of air flow where status is desired in both spaces	Simple temporary monitoring of airflow
Set Up	<ul style="list-style-type: none"> • Flush mount install with 2" holesaw or in standard single gang box • Install 24 VAC/VDC wiring 	<ul style="list-style-type: none"> • Flush mount install with 2" holesaw or in (2) standard single gang boxes OR • Flush mount install in place of previous thru wall monitor • Apply 24 VAC/VDC wiring 	<ul style="list-style-type: none"> • Quick-mount on a simple hook or screw • Apply 24 VAC/VDC via wiring or portable power supply
Kit Includes	<ul style="list-style-type: none"> • Setra Lite Base Unit - Specified by customer • Pressure Pickup Port (Setra RPS) • Mounting Hardware • Elbow Connectors • 250 ohm resistor (If wiring inputs for 4-20 mA current loops) 	<ul style="list-style-type: none"> • Setra Lite Base Unit - Specified by customer • LED alarm indicator with 30" cable • Pressure Pickup Port (Matching Dual Alert Variant) • 30" of rubber connecting tubing • Mounting Hardware • Elbow Connectors • 250 ohm resistor (If wiring inputs for 4-20 mA current loops) 	<ul style="list-style-type: none"> • Setra Lite Base Unit - Specified by customer • Pressure Pickup Port (Setra RPS) • Battery Pack • AC Adapter with 6-foot cord • Mounting bracket
Mounting	<ul style="list-style-type: none"> • Single-gang US electrical box, China 86 box, European back box, or equivalent interior dimensions • Direct to wall 	<ul style="list-style-type: none"> • Single-gang US electrical box, China 86 box, European back box, or equivalent interior dimensions • Direct to wall 	<ul style="list-style-type: none"> • Temporary mounting plate with single clearance hole
Sample Part Number	LITE050LBDWPV SAN	LITE050LBDWPV SAD	LITE050LBDWPV SAM

To order Quick-mount Kit without the base Lite, use part number 229451. To order Dual Alert Kit without the base Lite, use part number 380302.