

### 1 Connect AC or DC Power

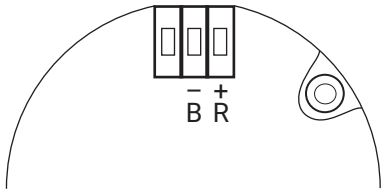

### 2 Connect Analog Output (If Needed)

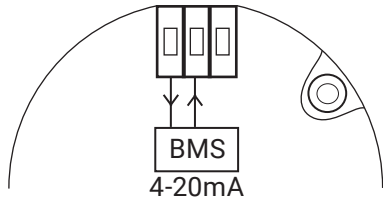
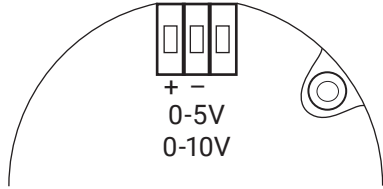

### 3 Connect Tubing & Mount Unit

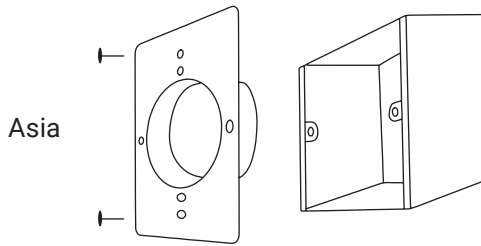
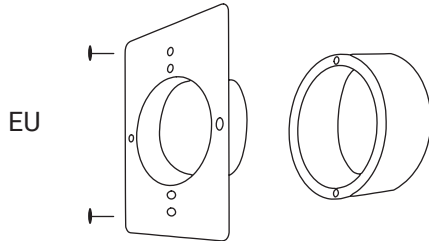
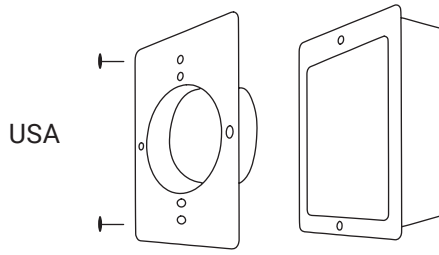

### 4 Configure

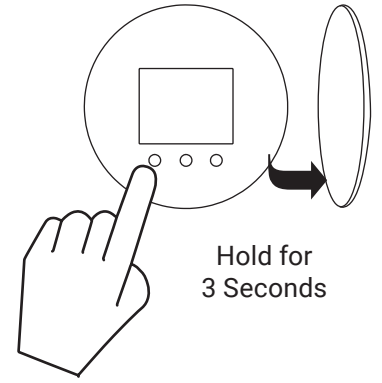

### Owner's Manual



[www.setra.com/setra-lite](http://www.setra.com/setra-lite)  
800.257.3872

setralite™

SS-Lite-Quickstart Rev. B 09/2024

### 1 Connect AC or DC Power

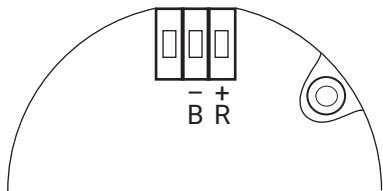

### 2 Connect Analog Output (If Needed)

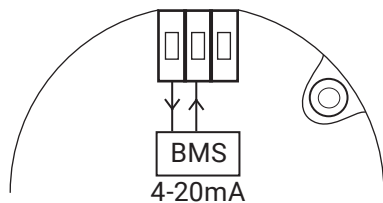
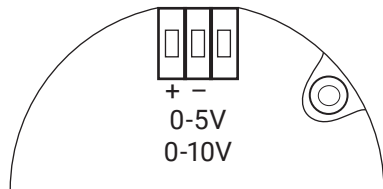

### 3 Connect Tubing & Mount Unit

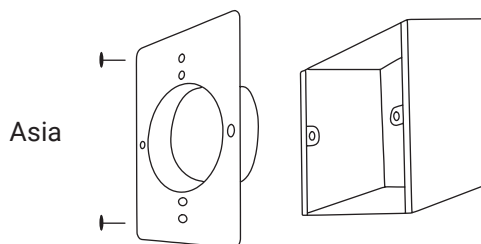
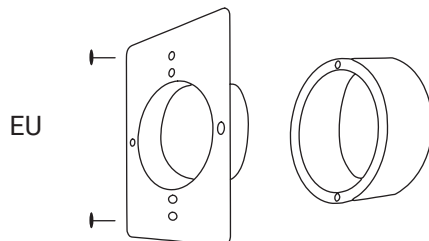
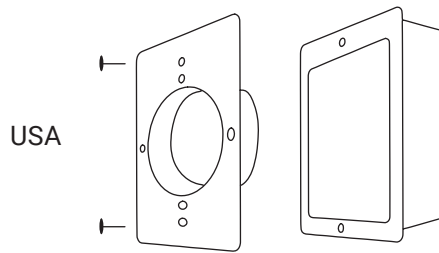

### 4 Configure

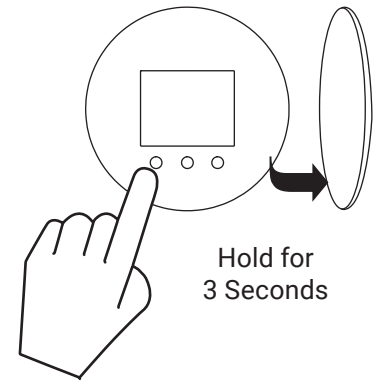

### Owner's Manual



[www.setra.com/setra-lite](http://www.setra.com/setra-lite)  
800.257.3872

setralite™

SS-Lite-Quickstart Rev. B 09/2024